



Appendix 2.12-3

Architectural Renderings

Architectural Renderings

1255 Hempstead Turnpike and 101 James Doolittle Boulevard, Uniondale, Town of Hempstead, Nassau County



1) View facing west from above Sands Boulevard toward the Central Plaza, with the Hotel Tower 1 visible at left, Hotel Tower 2 visible at right, and the gaming and parking facilities surrounding.

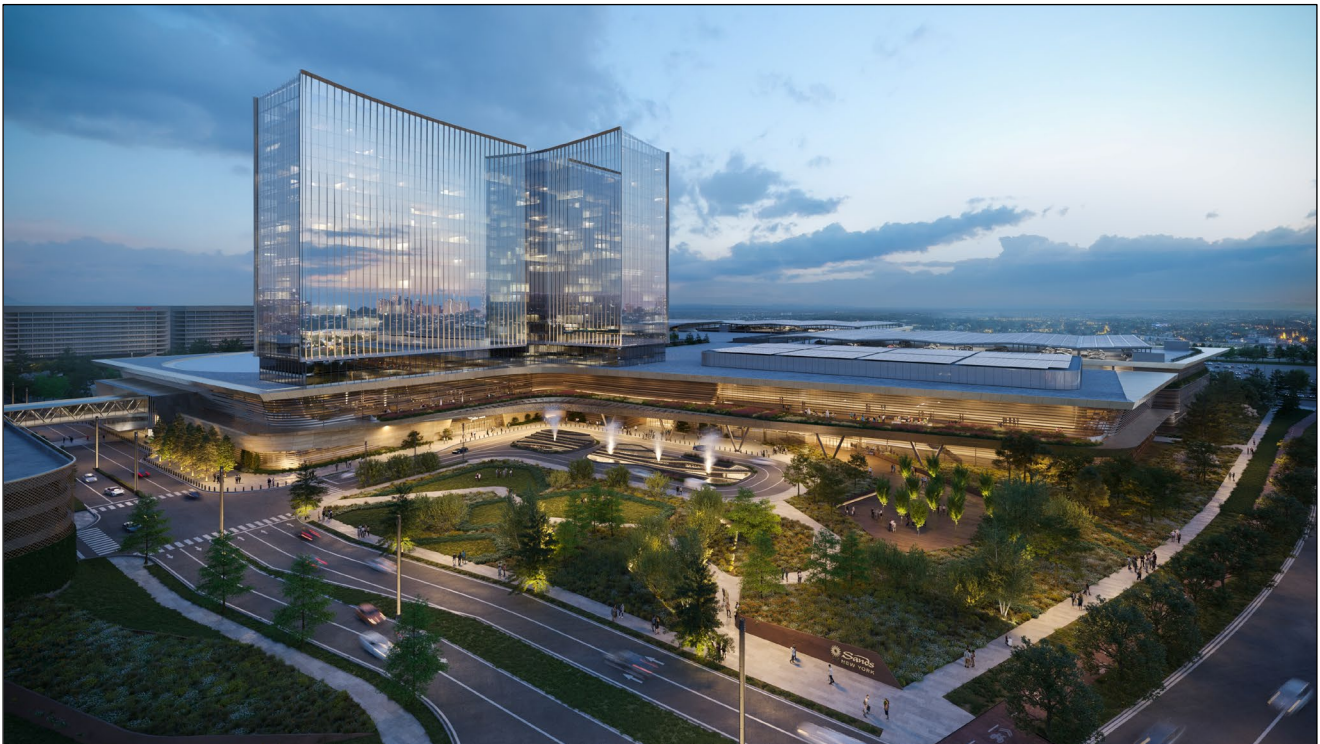

2) View facing southeast from above North Drive, with Hotel Tower 2 visible in the foreground, meeting and gaming facilities surrounding, and the existing Marriott Hotel visible in the background at left. Depicts evening conditions.

Architectural Renderings

1255 Hempstead Turnpike and 101 James Doolittle Boulevard, Uniondale, Town of Hempstead, Nassau County



3) Same viewpoint as no. 2, during daytime conditions.



4) View facing east from above Earle Ovington Boulevard toward the overall Integrated Resort and its surroundings.